

DATA SHEET. Model: MB-200L (12Vdc).

Centralizable Luminaire (without emergency light) of the Polar series.



Description

Centralizable luminaire for flush mounting.

Composed by two modules: luminaire and kit.

Illumination by means of LED crown (possibility of warm temperature colour: 3,000 K).

Minimalist design with transparent, soft opal (-8%) or strong opal (-30%) diffuser.

Technical characteristics

| | |
|------------------------|---|
| Lamp in emergency | N/A |
| Lamp in maintained | 6 x LED white 5,700 K |
| Flux in emergency | N/A |
| Flux in maintained | 200 lm (or 100 lm) |
| Charge indicator LED | N/A |
| Autonomy | N/A |
| Supply voltage | 12 Vdc |
| | 0 ÷ 40°C |
| Mains power | 2 W (or 1 W) |
| Battery | N/A |
| Remote controllable | N/A |
| Protection rating | IP42 - IK08 (IP55 possible) |
| Electrical insulation | Class II |
| Applicable legislation | CE marking (93/68/CEE): 2014/35/EU 2014/30/EU 2011/65/EU |

Photometric curve

N/A

Dimensions

Flush mounting

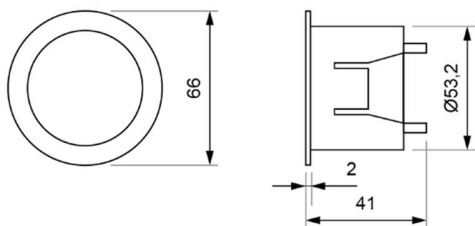

DATA SHEET. Model: MB-200L (12Vdc) _ Rev. 01 (March 2024)



LUZNOR Desarrollos Electrónicos, S.L.
Paduleta, 47 · 01015 · Vitoria-Gasteiz · 945 200 961
NIF: B01266451 · luznor@luznor.com · www.luznor.com

